

Panasonic KX-NS700 3rd Party SIP Phone / KX-TGP-500 Telquest Tech Support

This Help Sheet explains how to set up the KX-NS700 KSU to allow a 3rd Party SIP Phone to work.

The router info is basic and it is up to you determine how to make the changes in your particular router.

The Panasonic KX-TGP Cordless is considered a 3rd Party SIP Phone by the KSU.

It is up to you to program your 3rd Party SIP Phone to work properly.

We provide no Tech Support for your router.

We also assume that you are a qualified Telecom Tech with Panasonic programming experience.

If you are unable to understand this Help Sheet then you will need to bring in a local person that is an experienced, qualified Panasonic technician and has an understands IT Networking.

You will need to know the following information before you can proceed.

The Static Public IP Address of the router that the KSU is connected to.

If it is not a Static IP Address then you will need to either get a Static IP Address from your Internet Provider or look into subscribing to a Dynamic DNS URL from www.dydns.com

If you look into getting a Dynamic DNS URL then be sure that your router supports it.

You will also need 2 Static LAN IP Addresses along with the LAN Subnet Mask and Router Address.

Setting up and changing the Default KSU IP Addresses is not covered in this Help Sheet.

You must also have a SIP Extension License for EACH remote 3rd Party SIP Phone.

Activated feature	Pre-installed	Activation key	Features in total
IP Trunk (ch)	0	0	0
IP Proprietary Telephone/IP Softphone/ P-SIP Extension (ch)	0	0	0
IP Proprietary Telephone/P-SIP Extension (ch)	4	0	4
SIP Extension (ch)	0	1	1
Expansion Capacity	0	0	0
IP-CS channel expansion (CS unit)	-	-	-
One-look Network	-	-	-
QSIG Network	-	-	-
Two-way Recording Control	-	-	-
Message Backup	-	-	-
UM Port (ch)	-	-	-

Licenses

KX-NSM701 = 1 SIP Phone

KX-NSM705 = 5 SIP Phones

Start the Panasonic Web Maintenance Console program and connect to the KSU.

At the bottom of the screen, Mouse Over the Virtual Slot and then click on Select Shelf.



Next Screen:

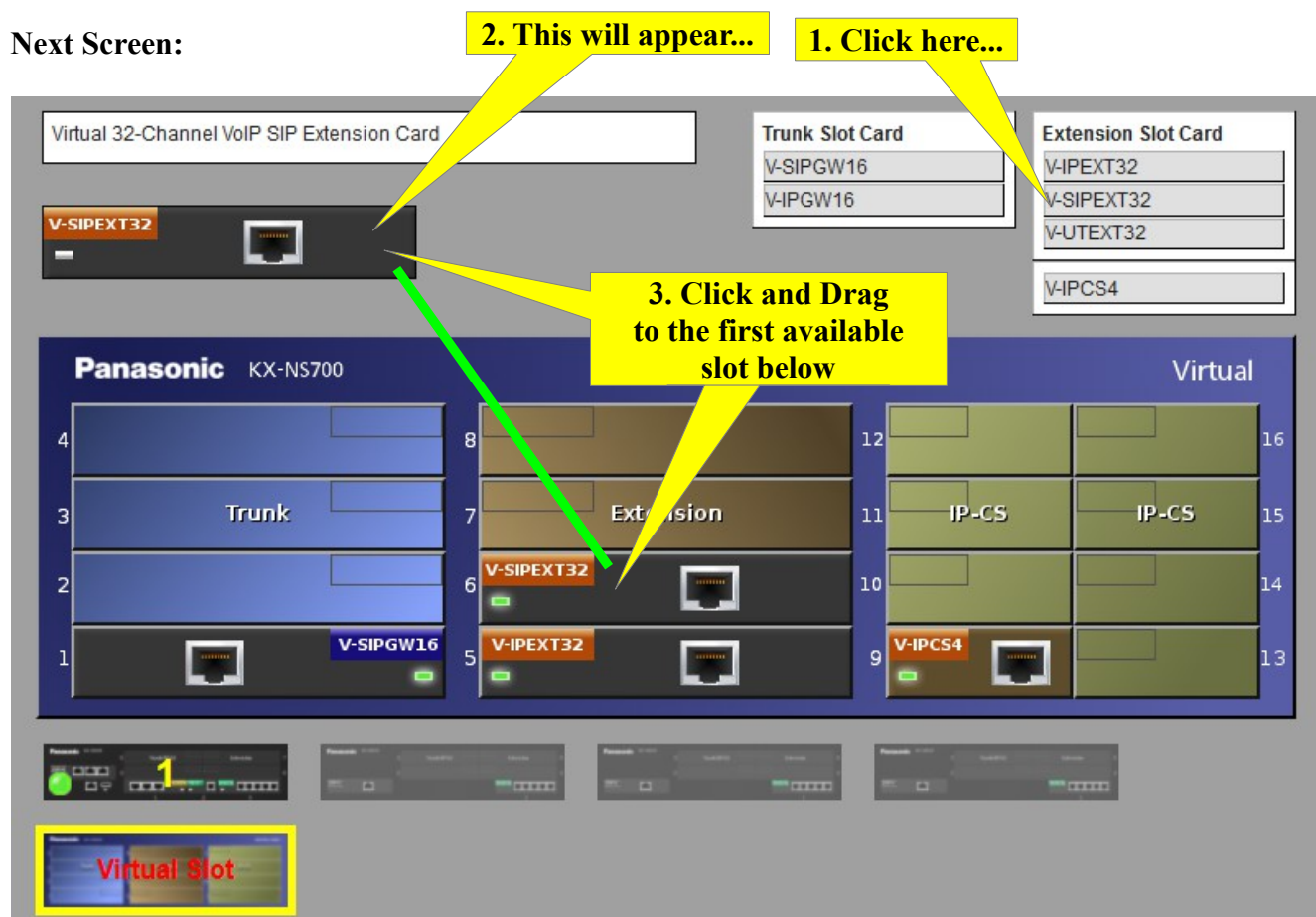

Same screen:

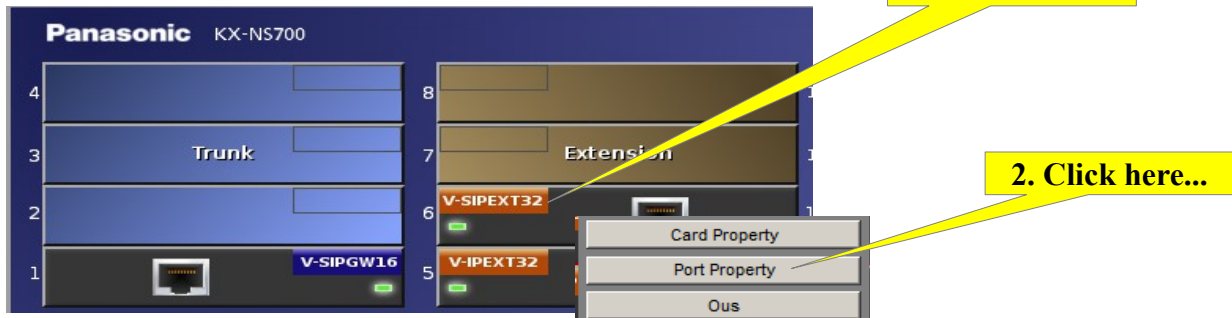

Next screen:

I have cut the screens down to minimize the view.

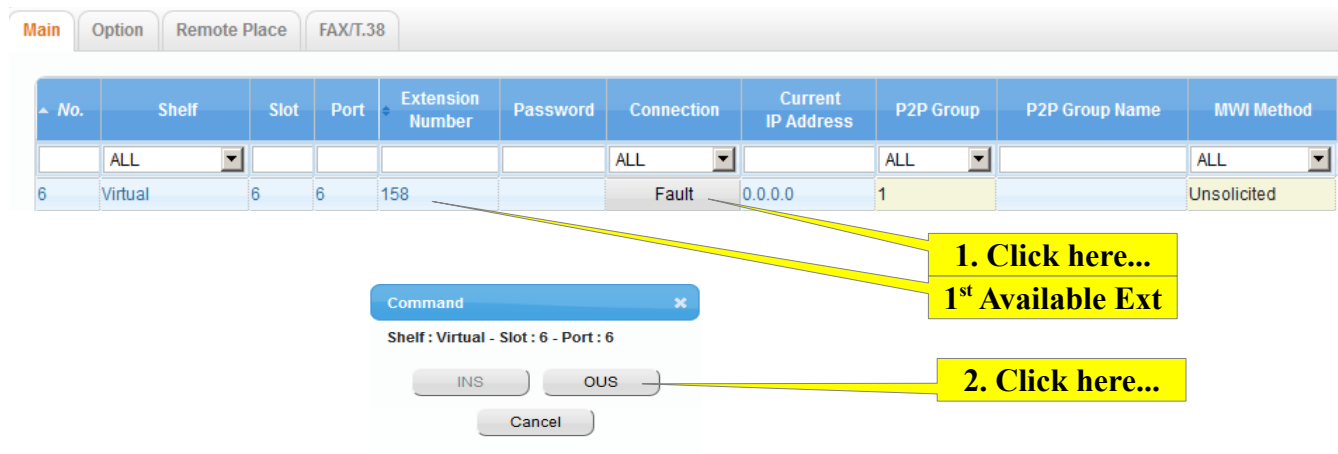

Same screen:

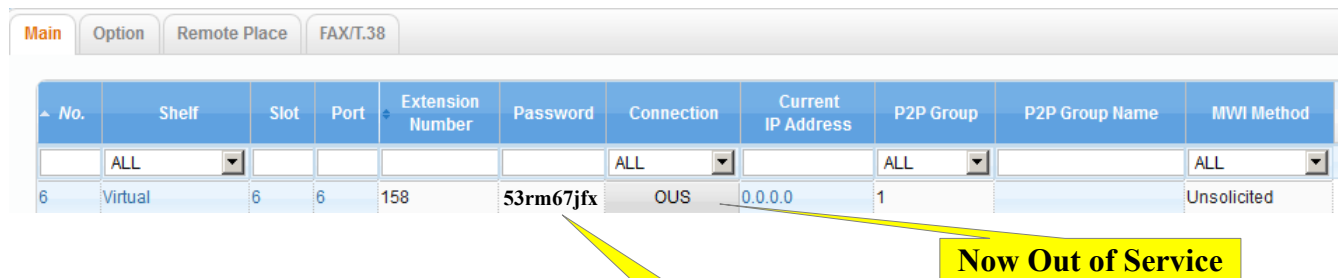

Be security aware.
Do not use 1234 or anything simple.
Use something like
27jw947x or 53rm67jfx

1. Add a password.
This will be the SIP Password
used for SIP Registration
AKA: SIP Authentication

Same screen:

1. Click here...

Main Option Remote Place FAX/T.38										
No.	Shelf	Slot	Port	Extension Number	Password	Connection	Current IP Address	P2P Group	P2P Group Name	MWI Method
	ALL					ALL		ALL		ALL
6	Virtual	6	6	158	53rm67jfx	OUS	0.0.0.0	1		Unsolicited

Next screen:

1. Click here...

Main Option Remote Place FAX/T.38							
No.	Shelf	Slot	Port	Extension Number	Password	Connection	Phone Location
	ALL					ALL	ALL
6	Virtual	6	6	158	53rm67jfx	OUS	Local
7	Virtual	6	7	159		Fault	Local
8	Virtual	6	8	160		Fault	Remote (MRG)

2. Select Remote (MRG)

MRG=Media Relay Gateway

Same screen:

Main Option Remote Place FAX/T.38							
No.	Shelf	Slot	Port	Extension Number	Password	Connection	Phone Location
	ALL					ALL	ALL
6	Virtual	6	6	158	53rm67jfx	OUS	Remote (MRG)

It will look like this when done...

View 1-20 of 32

OKCancelApply

3. Click here...

Same screen:

Main Option Remote Place FAX/T.38							
▲ No.	Shelf	Slot	Port	Extension Number	Password	Connection	Phone Location
	ALL					ALL	ALL
6	Virtual	6	6	158	53rm67jfx	OUS	Remote (MRG)

4. Click here...

5. Click here...

Command

Shelf: Virtual - Slot: 6 - Port: 6

INS

OUS

Cancel

Same screen:

▲ No.	Shelf	Slot	Port	Extension Number	Password	Connection	Phone Location
	ALL					ALL	ALL
6	Virtual	6	6	158	53rm67jfx	Fault	Remote (MRG)

It will say Fault until the phone is Registered

That completes the programming to establish a Remote SIP Extension and its password.

There are more areas in the programming that need to be done.

Set Media Relay Gateway (MRG) values:

1. Click here...

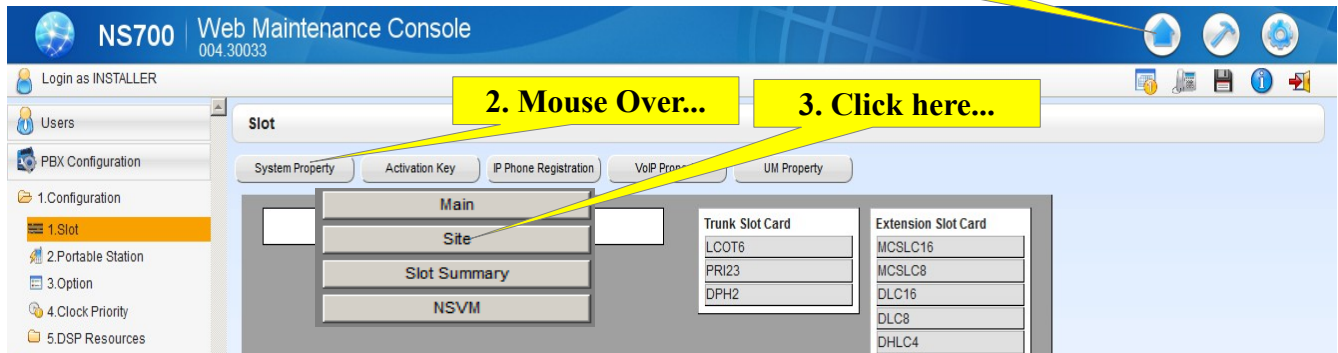

Next screen: It is cut down to save space.

1. Click here...

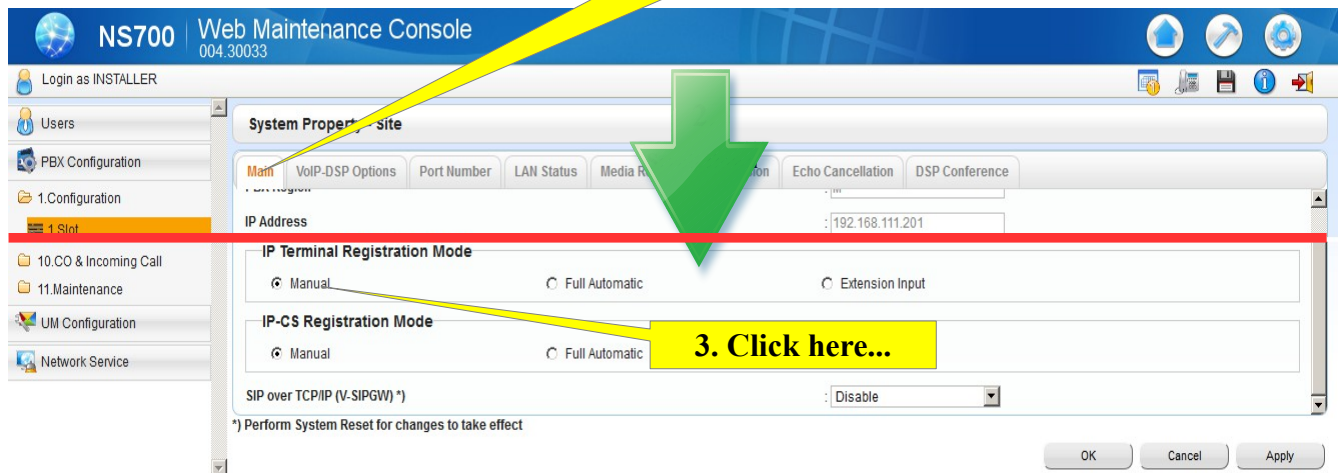

Next screen: It is cut down to save space.

1. Click here...

2. Enter YOUR Public Static IP Address

3. Click here...

Note:

Enter the Static Public IP Address of the router that YOUR KSU is connected to.

You must “Open / Port Forward” the following ports in the Network Router that the KSU is connected to.

This will allow the Remote SIP Phone to communicate with the KSU.

**Forward Port 15060 UDP to Port 5060 UDP to the LAN IP Address of the KSU.
(In my example it is 192.168.111.201 this is for SIP Messages)**

**Open Port Range 16000 to 16100 UDP to the LAN IP Address of the DSP Card.
(In my example it is 192.168.111.202 this is for RTP Voice)**

See Page 12 for more info.

Accessing the KXTGP-500 Web Browser

The KXTGP – 500 Web Browser is disabled by default.

To allow access to the Web Browser:

Press the Menu button IN

Dial #534 (POUND 534)

You will see “Embedded Web” in the LCD

Select ON

Press the Menu button IN

How to find the KXTGP – 500 IP Address

Press the Menu button IN

Dial #501 (POUND 501)

You will see “IP Address” in the LCD

The IP Address is just below it

Browser Default Logon Info:

Logon: admin

Password: adminpass

Enter the following information:

Panasonic
KX-TGP500B04

Status | Network | System | **VoIP** | Telephone | Maintenance

Web Port Close

SIP Settings [Line 1]

1. Click here... (points to the VoIP tab)

2. Click here... (points to the SIP Settings [Line 1] link in the left sidebar)

3. Enter Extension Number (points to the Phone Number field)

4. Enter KSU LAN IP Address (points to the Registrar Server Address field)

5. Enter 15060 (points to the Registrar Server Port field)

6. Enter KSU Public IP Address (points to the Outbound Proxy Server Address field)

7. Enter 15060 (points to the Outbound Proxy Server Port field)

8. Enter KSU LAN IP Address (points to the SIP Source Port field)

9. Enter Extension Number (points to the Authentication ID field)

10. Enter Password See Page 3 (points to the Authentication Password field)

11. Click here... (points to the Save button)

Phone Number

Phone Number: 158

Line ID:

SIP Server

Registrar Server Address: 192.168.111.201 (See Page 12)

Registrar Server Port: 15060 [1-65535]

Proxy Server Address:

Proxy Server Port: 5060 [1-65535]

Presence Server Address:

Presence Server Port: 5060 [1-65535]

Outbound Proxy Server

Outbound Proxy Server Address: 24.22.155.45 (See Page 7)

Outbound Proxy Server Port: 15060 [1-65535]

SIP Service Domain

Service Domain: 192.168.111.201

SIP Source Port

Source Port: 5060 [1024-49151]

SIP Authentication

Authentication ID: 158

Authentication Password:

Save Cancel

The Web Browser for the KX-TGP 500 will stay open for 30 minutes.

If you lose connectivity to the KX-TGP 500, then use Page 8 again.

At this point, the LED on the KX-TGP 500 should be Steady Green.

This indicates that it is Registered to the KSU.

You should be able to dial and ring between the KX-TGP 500 and the NS700 KSU, but there will be no voice.

There is an additional setting that needs to be entered to allow voice, but it is not available through the Web Browser.

You will need to call your Telquest salesperson to get the current link that needs to be entered via the Web Browser.

See Page 11

If the LED on the KX-TGP 500 is Flashing Orange, then it is not Registered and you need to go over all your settings.

Note: Compatibility Issues

Since there are many different types of Routers and we cannot predict which units will and will not work.

If all methods fail, you can set up a VPN between the remote site and the KSU.

The VPN method always works if it is set up properly for SIP communications.

Once you have the link from your Telquest salesperson, enter it as shown below:

The screenshot shows the Panasonic KX-TGP500B04 web interface. At the top, there is a navigation bar with tabs: Status, Network, System, VoIP, Telephone, and Maintenance. The Maintenance tab is selected. Below the navigation bar, the title "Provisioning Maintenance" is displayed. On the left side, there is a sidebar menu with options: Firmware Maintenance, Local Firmware Update, Provisioning Maintenance (highlighted), Management Server, Reset to Defaults, and Restart. The main content area contains a form with the following fields:

Provisioning Maintenance	
Enable Provisioning	<input checked="" type="radio"/> Yes <input type="radio"/> No
Standard File URL	<input type="text"/>
Product File URL	<input type="text"/>
Master File URL	<input type="text"/>
Cyclic Auto Resync	<input type="radio"/> Yes <input checked="" type="radio"/> No
Resync Interval	<input type="text" value="10080"/> Minute(s) [1-40320]
Header Value for Resync	<input type="text" value="check-sync"/>

At the bottom of the form, there are "Save" and "Cancel" buttons. Four yellow callout boxes with arrows point to specific elements:

1. Click here... (points to the Maintenance tab)
2. Click here... (points to the Provisioning Maintenance menu item in the sidebar)
3. Paste the link here (points to the Master File URL input field)
4. Click here... (points to the Save button)

The KX-TGP 500 will re-boot and should have voice when it is done.

Identify LAN and DSP IP Addresses

1. Click here...

2. Click here and here..

The screenshot displays the 'Web Maintenance Console' for 'N700' with IP '01.30033'. The left sidebar shows a tree view with 'Network Service' expanded and 'IP 1.IP Address/Ports' selected. The main panel is titled 'IP Address/Ports' and has three tabs: 'Basic Settings' (active), 'Advanced Settings', and 'Reference'.

Basic Settings:

- IP Address of the KSU: 192.168.111.201 (highlighted with a red box and labeled 'LAN IP Address')
- MAC Address: 08:00:23:A6:2E:94
- Subnet Mask: 255.255.255.0
- Default Gateway: 192.168.111.1

DNS Setting:

- Port Number: 53
- ☐ Obtain DNS server address automatically
- ☒ Use the following DNS server address
 - Preferred DNS IP Address: 8.8.8.8
 - Alternative DNS IP Address: 8.8.4.4

DSP IP Setting:

- ☐ Obtain DSP IP address automatically
- ☒ Use the following DSP IP address
 - DSP Card - 1**
 - IP Address of the DSP Card: 192.168.111.202 (highlighted with a red box and labeled 'DSP IP Address')
 - MAC Address: 08:00:23:A6:2E:95